

Set Screw Style Steel Ball – Serrated – Inch

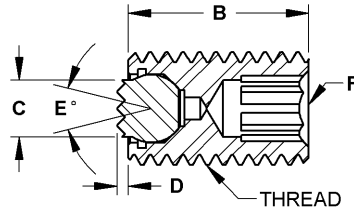
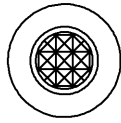

These thrust screw assemblies allow straight line static load thrust without transmitting torsional or radial force on to the work piece. The free floating ball design allows the thread to continue to rotate while the ball remains stationary against the surface. Ideal for irregular shaped or contoured work pieces. The housing is made from alloy steel, heat treated to Rc 43/46 with a black oxide finish. The replaceable ball is held in place with a viton O-ring which keeps contaminants out and allows the ball to swivel. The ball is made from M-2 high speed steel and heat treated to Rc 60/62. Replacement balls can be ordered separately. See page 4 for tooth pattern specifications.

INCH

Part Number	B Thread Length	C Contact Dia.	D Stand Off	E Degree Swivel	F Int Hex	Ball Dia	Ball Only Part Number	Tooth Pattern	Load Rating Lbs.
3/8-16 Threads									
TST-0370-S	1/2	5/32	1/16	28	3/16	3/16	BUB-187-S	SF	1,763
TST-0370 x .75-S	3/4	5/32	1/16	28	3/16	3/16	BUB-187-S	SF	1,763
TST-0375-S	1	5/32	1/16	28	3/16	3/16	BUB-187-S	SF	1,763
TST-0375 x 1.5-S	1 1/2	5/32	1/16	28	3/16	3/16	BUB-187-S	SF	1,763
TST-0375 x 2-S	2	5/32	1/16	28	3/16	3/16	BUB-187-S	SF	1,763
TST-0375 x 3-S	3	5/32	1/16	28	3/16	3/16	BUB-187-S	SF	1,763
3/8-24 Threads									
TST-0230-S	1/2	5/32	1/16	28	3/16	3/16	BUB-187-S	SF	1,763
TST-0230 x .75-S	3/4	5/32	1/16	28	3/16	3/16	BUB-187-S	SF	1,763
TST-0231-S	1	5/32	1/16	28	3/16	3/16	BUB-187-S	SF	1,763
TST-0231 x 1.5-S	1 1/2	5/32	1/16	28	3/16	3/16	BUB-187-S	SF	1,763
TST-0231 x 2-S	2	5/32	1/16	28	3/16	3/16	BUB-187-S	SF	1,763
TST-0231 x 3-S	3	5/32	1/16	28	3/16	3/16	BUB-187-S	SF	1,763
1/2-13 Threads									
TST-0513-S	3/4	1/4	1/16	28	1/4	9/32	BUB-200-S	SF	4,527
TST-0510-S	1	1/4	1/16	28	1/4	9/32	BUB-200-S	SF	4,527
TST-0510 x 1.5-S	1 1/2	1/4	1/16	28	1/4	9/32	BUB-200-S	SF	4,527
TST-0510 x 2-S	2	1/4	1/16	28	1/4	9/32	BUB-200-S	SF	4,527
TST-0510 x 3-S	3	1/4	1/16	28	1/4	9/32	BUB-200-S	SF	4,527
1/2-20 Threads									
TST-0503-S	3/4	1/4	1/16	28	1/4	9/32	BUB-200-S	SF	4,527
TST-0500-S	1	1/4	1/16	28	1/4	9/32	BUB-200-S	SF	4,527
TST-0500 x 1.5-S	1 1/2	1/4	1/16	28	1/4	9/32	BUB-200-S	SF	4,527
TST-0500 x 2-S	2	1/4	1/16	28	1/4	9/32	BUB-200-S	SF	4,527
TST-0500 x 3-S	3	1/4	1/16	28	1/4	9/32	BUB-200-S	SF	4,527
5/8-11 Threads									
TST-0625-S	1	5/16	1/16	28	5/16	3/8	BUB-300-S	EF	6,131
TST-0625 x 2-S	2	5/16	1/16	28	5/16	3/8	BUB-300-S	EF	6,131
TST-0625 x 3-S	3	5/16	1/16	28	5/16	3/8	BUB-300-S	EF	6,131
5/8-18 Threads									
TST-0620-S	1	5/16	1/16	28	5/16	3/8	BUB-300-S	EF	6,131
TST-0620 x 2-S	2	5/16	1/16	28	5/16	3/8	BUB-300-S	EF	6,131
TST-0620 x 3-S	3	5/16	1/16	28	5/16	3/8	BUB-300-S	EF	6,131
3/4-10 Threads									
TST-0755-S	1	3/8	1/8	32	3/8	1/2	BUB-500-S	EF	8,150
TST-0755 x 2-S	2	3/8	1/8	32	3/8	1/2	BUB-500-S	EF	8,150
TST-0755 x 3-S	3	3/8	1/8	32	3/8	1/2	BUB-500-S	EF	8,150
3/4-16 Threads									
TST-0750-S	1	3/8	1/8	32	3/8	1/2	BUB-500-S	EF	8,150
TST-0750 x 2-S	2	3/8	1/8	32	3/8	1/2	BUB-500-S	EF	8,150
TST-0750 x 3-S	3	3/8	1/8	32	3/8	1/2	BUB-500-S	EF	8,150
1-8 Threads									
TST-1108-S	1	1/2	1/8	40	3/8	5/8	BUB-600-S	FINE	14,757
TST-1108 x 2-S	2	1/2	1/8	40	3/8	5/8	BUB-600-S	FINE	14,757
TST-1108 x 3-S	3	1/2	1/8	40	3/8	5/8	BUB-600-S	FINE	14,757
1-14 Threads									
TST-1114-S	1	5/8	1/8	32	3/8	3/4	BUB-700-S	FINE	17,210
TST-1114 x 2-S	2	5/8	1/8	32	3/8	3/4	BUB-700-S	FINE	17,210
TST-1114 x 3-S	3	5/8	1/8	32	3/8	3/4	BUB-700-S	FINE	17,210

Set Screw Style Steel Ball – Flat – Inch

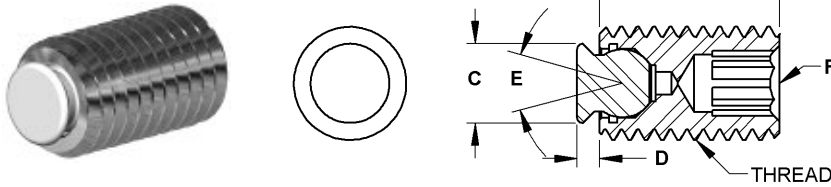

These thrust screw assemblies allow straight line static load thrust without transmitting torsional or radial force on to the work piece. The free floating ball design allows the thread to continue to rotate while the ball remains stationary against the surface. Ideal for irregular shaped or contoured work pieces. The housing is made from alloy steel, heat treated to Rc 43/46 with a black oxide finish. The replaceable ball is held in place with a viton O-ring which keeps contaminants out and allows the ball to swivel. The ball is made from M-2 high speed steel and heat treated to Rc 60/62. Replacement balls can be ordered separately.

INCH								
Part Number	B Thread Length	C Contact Dia.	D Stand Off	E Degree Swivel	F Int Hex	Ball Dia	Ball Only Part Number	Load Rating Lbs.
1/4-20 Threads								
TST-0250-FC	1/2	9/64	5/64	32	1/8	1/8	BUB-125-FC	---
TST-0251-FC	3/4	9/64	5/64	32	1/8	1/8	BUB-125-FC	---
TST-0251 x 1-FC	1	9/64	5/64	32	1/8	1/8	BUB-125-FC	---
1/4-28 Threads								
TST-0280-FC	1/2	9/64	5/64	32	1/8	1/8	BUB-125-FC	---
TST-0281-FC	3/4	9/64	5/64	32	1/8	1/8	BUB-125-FC	---
TST-0281 x 1-FC	1	9/64	5/64	32	1/8	1/8	BUB-125-FC	---
5/16-18 Threads								
TST-0310-FC	1/2	13/64	3/32	28	5/32	5/32	BUB-156-FC	---
TST-0312-FC	3/4	13/64	3/32	28	5/32	5/32	BUB-156-FC	---
TST-0312 x 1-FC	1	13/64	3/32	28	5/32	5/32	BUB-156-FC	---
TST-0312 x 1.5-FC	1 1/2	13/64	3/32	28	5/32	5/32	BUB-156-FC	---
5/16-24 Threads								
TST-0320-FC	1/2	13/64	3/32	28	5/32	5/32	BUB-156-FC	---
TST-0321-FC	3/4	13/64	3/32	28	5/32	5/32	BUB-156-FC	---
TST-0321 x 1-FC	1	13/64	3/32	28	5/32	5/32	BUB-156-FC	---
TST-0321 x 1.5-FC	1 1/2	13/64	3/32	28	5/32	5/32	BUB-156-FC	---
3/8-16 Threads								
TST-0370-FC	1/2	1/4	3/32	28	3/16	3/16	BUB-187-FC	1,763
TST-0370 x .75-FC	3/4	1/4	3/32	28	3/16	3/16	BUB-187-FC	1,763
TST-0375-FC	1	1/4	3/32	28	3/16	3/16	BUB-187-FC	1,763
TST-0375 x 1.5-FC	1 1/2	1/4	3/32	28	3/16	3/16	BUB-187-FC	1,763
TST-0375 x 2-FC	2	1/4	3/32	28	3/16	3/16	BUB-187-FC	1,763
TST-0375 x 3-FC	3	1/4	3/32	28	3/16	3/16	BUB-187-FC	1,763
3/8-24 Threads								
TST-0230-FC	1/2	1/4	3/32	28	3/16	3/16	BUB-187-FC	1,763
TST-0230 x .75-FC	3/4	1/4	3/32	28	3/16	3/16	BUB-187-FC	1,763
TST-0231-FC	1	1/4	3/32	28	3/16	3/16	BUB-187-FC	1,763
TST-0231 x 1.5-FC	1 1/2	1/4	3/32	28	3/16	3/16	BUB-187-FC	1,763
TST-0231 x 2-FC	2	1/4	3/32	28	3/16	3/16	BUB-187-FC	1,763
TST-0231 x 3-FC	3	1/4	3/32	28	3/16	3/16	BUB-187-FC	1,763
1/2-13 Threads								
TST-0513-FC	3/4	11/32	1/8	28	1/4	9/32	BUB-200-FC	4,527
TST-0510-FC	1	11/32	1/8	28	1/4	9/32	BUB-200-FC	4,527
TST-0510 x 1.5-FC	1 1/2	11/32	1/8	28	1/4	9/32	BUB-200-FC	4,527
TST-0510 x 2-FC	2	11/32	1/8	28	1/4	9/32	BUB-200-FC	4,527
TST-0510 x 3-FC	3	11/32	1/8	28	1/4	9/32	BUB-200-FC	4,527
1/2-20 Threads								
TST-0503-FC	3/4	11/32	1/8	28	1/4	9/32	BUB-200-FC	4,527
TST-0500-FC	1	11/32	1/8	28	1/4	9/32	BUB-200-FC	4,527
TST-0500 x 1.5-FC	1 1/2	11/32	1/8	28	1/4	9/32	BUB-200-FC	4,527
TST-0500 x 2-FC	2	11/32	1/8	28	1/4	9/32	BUB-200-FC	4,527
TST-0500 x 3-FC	3	11/32	1/8	28	1/4	9/32	BUB-200-FC	4,527

Set Screw Style Steel Ball – Flat – Inch (continued)

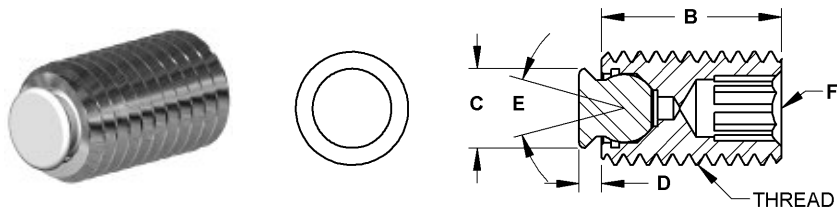

INCH (CONTINUED)

Part Number	B Thread Length	C Contact Dia.	D Stand Off	E Degree Swivel	F Int Hex	Ball Dia	Ball Only Part Number	Load Rating Lbs.
5/8-11 Threads								
TST-0625-FC	1	7/16	1/8	28	5/16	3/8	BUB-300-FC	6,131
TST-0625 x 2-FC	2	7/16	1/8	28	5/16	3/8	BUB-300-FC	6,131
TST-0625 x 3-FC	3	7/16	1/8	28	5/16	3/8	BUB-300-FC	6,131
5/8-18 Threads								
TST-0620-FC	1	7/16	1/8	28	5/16	3/8	BUB-300-FC	6,131
TST-0620 x 2-FC	2	7/16	1/8	28	5/16	3/8	BUB-300-FC	6,131
TST-0620 x 3-FC	3	7/16	1/8	28	5/16	3/8	BUB-300-FC	6,131
3/4-10 Threads								
TST-0755-FC	1	33/64	3/16	32	3/8	1/2	BUB-500-FC	8,150
TST-0755 x 2-FC	2	33/64	3/16	32	3/8	1/2	BUB-500-FC	8,150
TST-0755 x 3-FC	3	33/64	3/16	32	3/8	1/2	BUB-500-FC	8,150
3/4-16 Threads								
TST-0750-FC	1	33/64	3/16	32	3/8	1/2	BUB-500-FC	8,150
TST-0750 x 2-FC	2	33/64	3/16	32	3/8	1/2	BUB-500-FC	8,150
TST-0750 x 3-FC	3	33/64	3/16	32	3/8	1/2	BUB-500-FC	8,150
1-8 Threads								
TST-1108-FC	1	11/16	1/4	40	3/8	5/8	BUB-600-FC	14,757
TST-1108 x 2-FC	2	11/16	1/4	40	3/8	5/8	BUB-600-FC	14,757
TST-1108 x 3-FC	3	11/16	1/4	40	3/8	5/8	BUB-600-FC	14,757
1-14 Threads								
TST-1114-FC	1	49/64	1/4	32	3/8	3/4	BUB-700-FC	17,210
TST-1114 x 2-FC	2	49/64	1/4	32	3/8	3/4	BUB-700-FC	17,210
TST-1114 x 3-FC	3	49/64	1/4	32	3/8	3/4	BUB-700-FC	17,210

Set Screw Style Stainless Steel Ball – Round – Inch

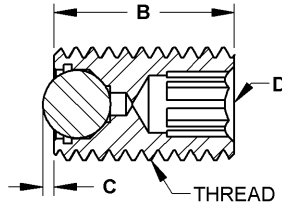
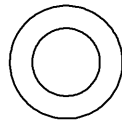

These thrust screw assemblies allow straight line static load thrust without transmitting torsional or radial force on to the work piece. The free floating ball design allows the thread to continue to rotate while the ball remains stationary against the surface. Ideal for irregular shaped or contoured work pieces. The housing is made from alloy steel, heat treated to Rc 43/46 with a black oxide finish. The replaceable ball is held in place with a viton O-ring which keeps contaminants out and allows the ball to swivel. The ball is made from 440c stainless steel and heat treated to Rc 55/60. Replacement balls can be ordered separately.

INCH													
Part Number	B Thread Length	C Stand Off	Ball Dia	Ball Only Part Number	D Int Hex	Load Rating Lbs.	Part Number	B Thread Length	C Stand Off	Ball Dia	Ball Only Part Number	D Int Hex	Load Rating Lbs.
5/16-18 Threads							5/8-11 Threads						
TST-0310-SB	1/2	.026	5/32	BUB-156-SB	5/32	-	TST-0625-SB	1	.063	3/8	BUB-300-SB	5/16	6,131
TST-0312-SB	3/4	.026	5/32	BUB-156-SB	5/32	-	TST-0625 x 2-SB	2	.063	3/8	BUB-300-SB	5/16	6,131
TST-0312 x 1-SB	1	.026	5/32	BUB-156-SB	5/32	-	TST-0625 x 3-SB	3	.063	3/8	BUB-300-SB	5/16	6,131
TST-0312 x 1.5-SB	1 1/2	.026	5/32	BUB-156-SB	5/32	-	5/8-18 Threads						
5/16-24 Threads							TST-0620-SB	1	.063	3/8	BUB-300-SB	5/16	6,131
TST-0320-SB	1/2	.026	5/32	BUB-156-SB	5/32	-	TST-0620 x 2-SB	2	.063	3/8	BUB-300-SB	5/16	6,131
TST-0321-SB	3/4	.026	5/32	BUB-156-SB	5/32	-	TST-0620 x 3-SB	3	.063	3/8	BUB-300-SB	5/16	6,131
TST-0321 x 1-SB	1	.026	5/32	BUB-156-SB	5/32	-	3/4-10 Threads						
TST-0321 x 1.5-SB	1 1/2	.026	5/32	BUB-156-SB	5/32	-	TST-0755-SB	1	.107	1/2	BUB-500-SB	3/8	8,150
3/8-16 Threads							TST-0755 x 2-SB	2	.107	1/2	BUB-500-SB	3/8	8,150
TST-0370-SB	1/2	.024	3/16	BUB-187-SB	3/16	1,763	TST-0755 x 3-SB	3	.107	1/2	BUB-500-SB	3/8	8,150
TST-0370 x .75-SB	3/4	.024	3/16	BUB-187-SB	3/16	1,763	3/4-16 Threads						
TST-0375-SB	1	.024	3/16	BUB-187-SB	3/16	1,763	TST-0750-SB	1	.107	1/2	BUB-500-SB	3/8	8,150
TST-0375 x 1.5-SB	1 1/2	.024	3/16	BUB-187-SB	3/16	1,763	TST-0750 x 2-SB	2	.107	1/2	BUB-500-SB	3/8	8,150
TST-0375 x 2-SB	2	.024	3/16	BUB-187-SB	3/16	1,763	TST-0750 x 3-SB	3	.107	1/2	BUB-500-SB	3/8	8,150
TST-0375 x 3-SB	3	.024	3/16	BUB-187-SB	3/16	1,763	1-8 Threads						
3/8-24 Threads							TST-1108-SB	1	.175	5/8	BUB-600-SB	3/8	14,757
TST-0230-SB	1/2	.024	3/16	BUB-187-SB	3/16	1,763	TST-1108 x 2-SB	2	.175	5/8	BUB-600-SB	3/8	14,757
TST-0230 x .75-SB	3/4	.024	3/16	BUB-187-SB	3/16	1,763	TST-1108 x 3-SB	3	.175	5/8	BUB-600-SB	3/8	14,757
TST-0231-SB	1	.024	3/16	BUB-187-SB	3/16	1,763	1-14 Threads						
TST-0231 x 1.5-SB	1 1/2	.024	3/16	BUB-187-SB	3/16	1,763	TST-1114-SB	1	.208	3/4	BUB-700-SB	3/8	17,210
TST-0231 x 2-SB	2	.024	3/16	BUB-187-SB	3/16	1,763	TST-1114 x 2-SB	2	.208	3/4	BUB-700-SB	3/8	17,210
TST-0231 x 3-SB	3	.024	3/16	BUB-187-SB	3/16	1,763	TST-1114 x 3-SB	3	.208	3/4	BUB-700-SB	3/8	17,210
1/2-13 Threads													
TST-0513-SB	3/4	.063	9/32	BUB-200-SB	1/4	4,527							
TST-0510-SB	1	.063	9/32	BUB-200-SB	1/4	4,527							
TST-0510 x 1.5-SB	1 1/2	.063	9/32	BUB-200-SB	1/4	4,527							
TST-0510 x 2-SB	2	.063	9/32	BUB-200-SB	1/4	4,527							
TST-0510 x 3-SB	3	.063	9/32	BUB-200-SB	1/4	4,527							
1/2-20 Threads													
TST-0503-SB	3/4	.063	9/32	BUB-200-SB	1/4	4,527							
TST-0500-SB	1	.063	9/32	BUB-200-SB	1/4	4,527							
TST-0500 x 1.5-SB	1 1/2	.063	9/32	BUB-200-SB	1/4	4,527							
TST-0500 x 2-SB	2	.063	9/32	BUB-200-SB	1/4	4,527							
TST-0500 x 3-SB	3	.063	9/32	BUB-200-SB	1/4	4,527							

Set Screw Style Delrin Ball – Round – Inch

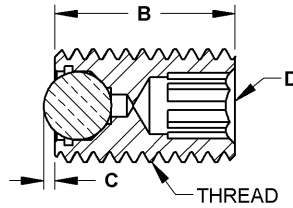
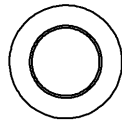

These thrust screw assemblies allow straight line static load thrust without transmitting torsional or radial force on to the work piece. The free floating ball design allows the thread to continue to rotate while the ball remains stationary against the surface. Ideal for irregular shaped or contoured work pieces. The housing is made from alloy steel, heat treated to Rc 43/46 with a black oxide finish. The replaceable ball is held in place with a viton O-ring which keeps contaminants out and allows the ball to swivel. The ball is made from non-marring white delrin. Replacement balls can be ordered separately. The ball is made from non-marring white Delrin.

INCH											
Part Number	B Thread Length	C Stand Off	Ball Dia	Ball Only Part Number	D Int Hex	Part Number	B Thread Length	C Stand Off	Ball Dia	Ball Only Part Number	D Int Hex
5/16-18 Threads						5/8-11 Threads					
TST-0310-DB	1/2	.026	5/32	BUB-156-DB	5/32	TST-0625-DB	1	.063	3/8	BUB-300-DB	5/16
TST-0312-DB	3/4	.026	5/32	BUB-156-DB	5/32	TST-0625 x 2-DB	2	.063	3/8	BUB-300-DB	5/16
TST-0312 x 1-DB	1	.026	5/32	BUB-156-DB	5/32	TST-0625 x 3-DB	3	.063	3/8	BUB-300-DB	5/16
TST-0312 x 1.5-DB	1 1/2	.026	5/32	BUB-156-DB	5/32	5/8-18 Threads					
5/16-24 Threads						TST-0620-DB	1	.063	3/8	BUB-300-DB	5/16
TST-0320-DB	1/2	.026	5/32	BUB-156-DB	5/32	TST-0620 x 2-DB	2	.063	3/8	BUB-300-DB	5/16
TST-0321-DB	3/4	.026	5/32	BUB-156-DB	5/32	TST-0620 x 3-DB	3	.063	3/8	BUB-300-DB	5/16
TST-0321 x 1-DB	1	.026	5/32	BUB-156-DB	5/32	3/4-10 Threads					
TST-0321 x 1.5-DB	1 1/2	.026	5/32	BUB-156-DB	5/32	TST-0755-DB	1	.107	1/2	BUB-500-DB	3/8
3/8-16 Threads						TST-0755 x 2-DB	2	.107	1/2	BUB-500-DB	3/8
TST-0370-DB	1/2	.024	3/16	BUB-187-DB	3/16	TST-0755 x 3-DB	3	.107	1/2	BUB-500-DB	3/8
TST-0370 x .75-DB	3/4	.024	3/16	BUB-187-DB	3/16	3/4-16 Threads					
TST-0375-DB	1	.024	3/16	BUB-187-DB	3/16	TST-0750-DB	1	.107	1/2	BUB-500-DB	3/8
TST-0375 x 1.5-DB	1 1/2	.024	3/16	BUB-187-DB	3/16	TST-0750 x 2-DB	2	.107	1/2	BUB-500-DB	3/8
TST-0375 x 2-DB	2	.024	3/16	BUB-187-DB	3/16	TST-0750 x 3-DB	3	.107	1/2	BUB-500-DB	3/8
TST-0375 x 3-DB	3	.024	3/16	BUB-187-DB	3/16	1-8 Threads					
3/8-24 Threads						TST-1108-DB	1	.175	5/8	BUB-600-DB	3/8
TST-0230-DB	1/2	.024	3/16	BUB-187-DB	3/16	TST-1108 x 2-DB	2	.175	5/8	BUB-600-DB	3/8
TST-0230 x .75-DB	3/4	.024	3/16	BUB-187-DB	3/16	TST-1108 x 3-DB	3	.175	5/8	BUB-600-DB	3/8
TST-0231-DB	1	.024	3/16	BUB-187-DB	3/16	1-14 Threads					
TST-0231 x 1.5-DB	1 1/2	.024	3/16	BUB-187-DB	3/16	TST-1114-DB	1	.208	3/4	BUB-700-DB	3/8
TST-0231 x 2-DB	2	.024	3/16	BUB-187-DB	3/16	TST-1114 x 2-DB	2	.208	3/4	BUB-700-DB	3/8
TST-0231 x 3-DB	3	.024	3/16	BUB-187-DB	3/16	TST-1114 x 3-DB	3	.208	3/4	BUB-700-DB	3/8
1/2-13 Threads											
TST-0513-DB	3/4	.063	9/32	BUB-200-DB	1/4						
TST-0510-DB	1	.063	9/32	BUB-200-DB	1/4						
TST-0510 x 1.5-DB	1 1/2	.063	9/32	BUB-200-DB	1/4						
TST-0510 x 2-DB	2	.063	9/32	BUB-200-DB	1/4						
TST-0510 x 3-DB	3	.063	9/32	BUB-200-DB	1/4						
1/2-20 Threads											
TST-0503-DB	3/4	.063	9/32	BUB-200-DB	1/4						
TST-0500-DB	1	.063	9/32	BUB-200-DB	1/4						
TST-0500 x 1.5-DB	1 1/2	.063	9/32	BUB-200-DB	1/4						
TST-0500 x 2-DB	2	.063	9/32	BUB-200-DB	1/4						
TST-0500 x 3-DB	3	.063	9/32	BUB-200-DB	1/4						

Set Screw Style Delrin Ball – Flat – Inch

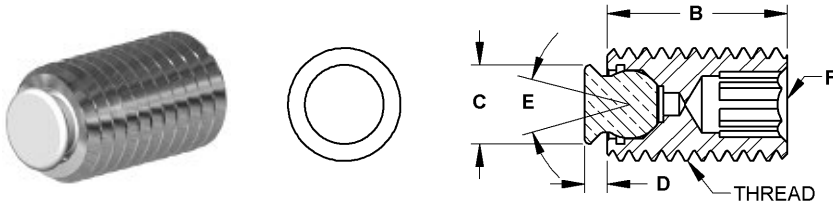

These thrust screw assemblies allow straight line static load thrust without transmitting torsional or radial force on to the work piece. The free floating ball design allows the thread to continue to rotate while the ball remains stationary against the surface. Ideal for irregular shaped or contoured work pieces. The housing is made from alloy steel, heat treated to Rc 43/46 with a black oxide finish. The replaceable ball is held in place with a viton O-ring which keeps contaminants out and allows the ball to swivel. The ball is made from non-marring white delrin and ground flat. Replacement balls can be ordered separately.

INCH							
Part Number	B Thread Length	C Contact Dia.	C Stand Off	E Degree Swivel	F Int Hex	Ball Dia	Ball Only Part Number
1/4-20 Threads							
TST-0250-DC	1/2	9/64	5/64	32	1/8	1/8	BUB-125-DC
TST-0251-DC	3/4	9/64	5/64	32	1/8	1/8	BUB-125-DC
TST-0251 x 1-DC	1	9/64	5/64	32	1/8	1/8	BUB-125-DC
1/4-28 Threads							
TST-0280-DC	1/2	9/64	5/64	32	1/8	1/8	BUB-125-DC
TST-0281-DC	3/4	9/64	5/64	32	1/8	1/8	BUB-125-DC
TST-0281 x 1-DC	1	9/64	5/64	32	1/8	1/8	BUB-125-DC
5/16-18 Threads							
TST-0310-DC	1/2	13/64	3/32	28	5/32	5/32	BUB-156-DC
TST-0312-DC	3/4	13/64	3/32	28	5/32	5/32	BUB-156-DC
TST-0312 x 1-DC	1	13/64	3/32	28	5/32	5/32	BUB-156-DC
TST-0312 x 1.5-DC	1 1/2	13/64	3/32	28	5/32	5/32	BUB-156-DC
5/16-24 Threads							
TST-0320-DC	1/2	13/64	3/32	28	5/32	5/32	BUB-156-DC
TST-0321-DC	3/4	13/64	3/32	28	5/32	5/32	BUB-156-DC
TST-0321 x 1-DC	1	13/64	3/32	28	5/32	5/32	BUB-156-DC
TST-0321 x 1.5-DC	1 1/2	13/64	3/32	28	5/32	5/32	BUB-156-DC
3/8-16 Threads							
TST-0370-DC	1/2	1/4	3/32	28	3/16	3/16	BUB-187-DC
TST-0370 x .75-DC	3/4	1/4	3/32	28	3/16	3/16	BUB-187-DC
TST-0375-DC	1	1/4	3/32	28	3/16	3/16	BUB-187-DC
TST-0375 x 1.5-DC	1 1/2	1/4	3/32	28	3/16	3/16	BUB-187-DC
TST-0375 x 2-DC	2	1/4	3/32	28	3/16	3/16	BUB-187-DC
TST-0375 x 3-DC	3	1/4	3/32	28	3/16	3/16	BUB-187-DC
3/8-24 Threads							
TST-0230-DC	1/2	1/4	3/32	28	3/16	3/16	BUB-187-DC
TST-0230 x .75-DC	3/4	1/4	3/32	28	3/16	3/16	BUB-187-DC
TST-0231-DC	1	1/4	3/32	28	3/16	3/16	BUB-187-DC
TST-0231 x 1.5-DC	1 1/2	1/4	3/32	28	3/16	3/16	BUB-187-DC
TST-0231 x 2-DC	2	1/4	3/32	28	3/16	3/16	BUB-187-DC
TST-0231 x 3-DC	3	1/4	3/32	28	3/16	3/16	BUB-187-DC
1/2-13 Threads							
TST-0513-DC	3/4	11/32	1/8	28	1/4	9/32	BUB-200-DC
TST-0510-DC	1	11/32	1/8	28	1/4	9/32	BUB-200-DC
TST-0510 x 1.5-DC	1 1/2	11/32	1/8	28	1/4	9/32	BUB-200-DC
TST-0510 x 2-DC	2	11/32	1/8	28	1/4	9/32	BUB-200-DC
TST-0510 x 3-DC	3	11/32	1/8	28	1/4	9/32	BUB-200-DC
1/2-20 Threads							
TST-0503-DC	3/4	11/32	1/8	28	1/4	9/32	BUB-200-DC
TST-0500-DC	1	11/32	1/8	28	1/4	9/32	BUB-200-DC
TST-0500 x 1.5-DC	1 1/2	11/32	1/8	28	1/4	9/32	BUB-200-DC
TST-0500 x 2-DC	2	11/32	1/8	28	1/4	9/32	BUB-200-DC
TST-0500 x 3-DC	3	11/32	1/8	28	1/4	9/32	BUB-200-DC

Set Screw Style Delrin Ball – Flat – Inch (continued)

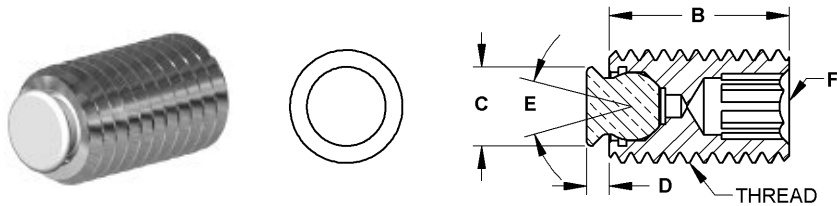

INCH (CONTINUED)

Part Number	B Thread Length	C Contact Dia.	C Stand Off	E Degree Swivel	F Int Hex	Ball Dia	Ball Only Part Number
5/8-11 Threads							
TST-0625-DC	1	7/16	1/8	28	5/16	3/8	BUB-300-DC
TST-0625 x 2-DC	2	7/16	1/8	28	5/16	3/8	BUB-300-DC
TST-0625 x 3-DC	3	7/16	1/8	28	5/16	3/8	BUB-300-DC
5/8-18 Threads							
TST-0620-DC	1	7/16	1/8	28	5/16	3/8	BUB-300-DC
TST-0620 x 2-DC	2	7/16	1/8	28	5/16	3/8	BUB-300-DC
TST-0620 x 3-DC	3	7/16	1/8	28	5/16	3/8	BUB-300-DC
3/4-10 Threads							
TST-0755-DC	1	33/64	3/16	32	3/8	1/2	BUB-500-DC
TST-0755 x 2-DC	2	33/64	3/16	32	3/8	1/2	BUB-500-DC
TST-0755 x 3-DC	3	33/64	3/16	32	3/8	1/2	BUB-500-DC
3/4-16 Threads							
TST-0750-DC	1	33/64	3/16	32	3/8	1/2	BUB-500-DC
TST-0750 x 2-DC	2	33/64	3/16	32	3/8	1/2	BUB-500-DC
TST-0750 x 3-DC	3	33/64	3/16	32	3/8	1/2	BUB-500-DC
1-8 Threads							
TST-1108-DC	1	11/16	1/4	40	3/8	5/8	BUB-600-DC
TST-1108 x 2-DC	2	11/16	1/4	40	3/8	5/8	BUB-600-DC
TST-1108 x 3-DC	3	11/16	1/4	40	3/8	5/8	BUB-600-DC
1-14 Threads							
TST-1114-DC	1	49/64	1/4	32	3/8	3/4	BUB-700-DC
TST-1114 x 2-DC	2	49/64	1/4	32	3/8	3/4	BUB-700-DC
TST-1114 x 3-DC	3	49/64	1/4	32	3/8	3/4	BUB-700-DC

Socket Head Style Steel Ball – Serrated – Inch

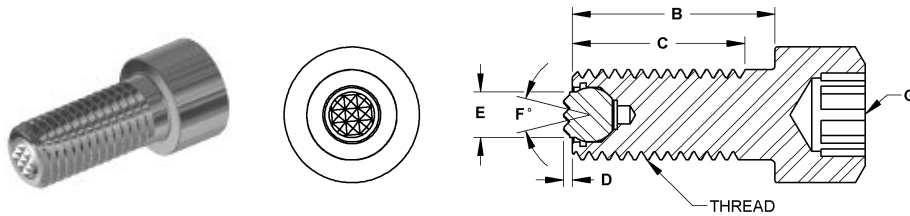

These thrust screw assemblies allow straight line static load thrust without transmitting torsional or radial force on to the work piece. The free floating ball design allows the thread to continue to rotate while the ball remains stationary against the surface. Ideal for irregular shaped or contoured work pieces. The housing is made from alloy steel, heat treated to Rc 43/46 with a black oxide finish. The replaceable ball is held in place with a viton O-ring which keeps contaminants out and allows the ball to swivel. The ball is made from M-2 high speed steel and heat treated to Rc 60/62. Replacement balls can be ordered separately. See page 4 for tooth pattern specifications.

INCH

Part Number	B Shank Length	C Thread Length	D Stand Off	E Contact Dia.	F Degree Swivel	G Int Hex	Ball Dia	Ball Only Part Number	Tooth Pattern	Load Rating Lbs.
3/8-16 Threads										
TSH-0375-S	1	1	1/16	5/32	28	5/16	3/16	BUB-187-S	SF	1,763
TSH-0375 x 1.5-S	1 1/2	1 1/2	1/16	5/32	28	5/16	3/16	BUB-187-S	SF	1,763
TSH-0375 x 2-S	2	1 1/4	1/16	5/32	28	5/16	3/16	BUB-187-S	SF	1,763
TSHF-0375 x 2-S	2	2	1/16	5/32	28	5/16	3/16	BUB-187-S	SF	1,763
TSH-0375 x 2.5-S	2 1/2	1 1/4	1/16	5/32	28	3/16	3/16	BUB-187-S	SF	1,763
TSHF-0375 x 2.5-S	2 1/2	2 1/2	1/16	5/32	28	3/16	3/16	BUB-187-S	SF	1,763
3/8-24 Threads										
TSH-0231-S	1	1	1/16	5/32	28	5/16	3/16	BUB-187-S	SF	1,763
TSH-0231 x 1.5-S	1 1/2	1 1/2	1/16	5/32	28	5/16	3/16	BUB-187-S	SF	1,763
TSH-0231 x 2-S	2	1 1/4	1/16	5/32	28	5/16	3/16	BUB-187-S	SF	1,763
TSHF-0231 x 2-S	2	2	1/16	5/32	28	5/16	3/16	BUB-187-S	SF	1,763
TSH-0231 x 2.5-S	2 1/2	1 1/4	1/16	5/32	28	5/16	3/16	BUB-187-S	SF	1,763
TSHF-0231 x 2.5-S	2 1/2	2 1/2	1/16	5/32	28	5/16	3/16	BUB-187-S	SF	1,763
1/2-13 Threads										
TSH-0510 x 1.25-S	1 1/4	1 1/4	1/16	1/4	28	3/8	9/32	BUB-200-S	SF	4,575
TSH-0510 x 1.5-S	1 1/2	1 1/2	1/16	1/4	28	3/8	9/32	BUB-200-S	SF	4,575
TSH-0510 x 2-S	2	2	1/16	1/4	28	3/8	9/32	BUB-200-S	SF	4,575
TSH-0510 x 2.5-S	2 1/2	1 1/2	1/16	1/4	28	3/8	9/32	BUB-200-S	SF	4,575
TSHF-0510 x 2.5-S	2 1/2	2 1/2	1/16	1/4	28	3/8	9/32	BUB-200-S	SF	4,575
TSH-0510 x 3-S	3	1 1/2	1/16	1/4	28	3/8	9/32	BUB-200-S	SF	4,575
TSHF-0510 x 3-S	3	3	1/16	1/4	28	3/8	9/32	BUB-200-S	SF	4,575
1/2-20 Threads										
TSH-0500 x 1.25-S	1 1/4	1 1/4	1/16	1/4	28	3/8	9/32	BUB-200-S	SF	4,575
TSH-0500 x 1.5-S	1 1/2	1 1/2	1/16	1/4	28	3/8	9/32	BUB-200-S	SF	4,575
TSH-0500 x 2-S	2	2	1/16	1/4	28	3/8	9/32	BUB-200-S	SF	4,575
TSH-0500 x 2.5-S	2 1/2	1 1/2	1/16	1/4	28	3/8	9/32	BUB-200-S	SF	4,575
TSHF-0500 x 2.5-S	2 1/2	2 1/2	1/16	1/4	28	3/8	9/32	BUB-200-S	SF	4,575
TSH-0500 x 3-S	3	1 1/2	1/16	1/4	26	3/8	9/32	BUB-200-S	SF	4,575
TSHF-0500 x 3-S	3	3	1/16	1/4	26	3/8	9/32	BUB-200-S	SF	4,575
5/8-11 Threads										
TSH-0625-S	1 1/2	1 3/4	1/16	5/16	28	1/2	3/8	BUB-300-S	EF	6,131
TSH-0625 x 2-S	2	2	1/16	5/16	28	1/2	3/8	BUB-300-S	EF	6,131
TSH-0625 x 2.5-S	2 1/2	1 3/4	1/16	5/16	28	1/2	3/8	BUB-300-S	EF	6,131
TSHF-0625 x 2.5-S	2 1/2	2 1/2	1/16	5/16	28	1/2	3/8	BUB-300-S	EF	6,131
TSH-0625 x 3-S	3	1 3/4	1/16	5/16	28	1/2	3/8	BUB-300-S	EF	6,131
TSHF-0625 x 3-S	3	3	1/16	5/16	28	1/2	3/8	BUB-300-S	EF	6,131
5/8-18 Threads										
TSH-0620-S	1 1/2	1 1/2	1/16	5/16	28	1/2	3/8	BUB-300-S	EF	6,131
TSH-0620 x 2-S	2	2	1/16	5/16	28	1/2	3/8	BUB-300-S	EF	6,131
TSH-0620 x 2.5-S	2 1/2	1 3/4	1/16	5/16	28	1/2	3/8	BUB-300-S	EF	6,131
TSHF-0620 x 2.5-S	2 1/2	2 1/2	1/16	5/16	28	1/2	3/8	BUB-300-S	EF	6,131
TSH-0620 x 3-S	3	1 3/4	1/16	5/16	28	1/2	3/8	BUB-300-S	EF	6,131
TSHF-0620 x 3-S	3	3	1/16	5/16	28	1/2	3/8	BUB-300-S	EF	6,131

Socket Head Style Steel Ball – Serrated – Inch (continued)

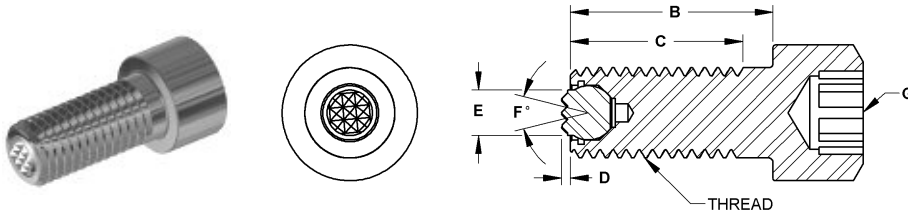

INCH (CONTINUED)

Part Number	B Shank Length	C Thread Length	D Stand Off	E Contact Dia.	F Degree Swivel	G Int Hex	Ball Dia	Ball Only Part Number	Tooth Pattern	Load Rating Lbs.
3/4-10 Threads										
TSH-0755 x 2-S	2	2	1/8	3/8	32	5/8	1/2	BUB-500-S	EF	8,150
TSH-0755 x 2.5-S	2 1/2	2 1/2	1/8	3/8	32	5/8	1/2	BUB-500-S	EF	8,150
TSH-0755 x 3-S	3	2 1/2	1/8	3/8	32	5/8	1/2	BUB-500-S	EF	8,150
TSHF-0755 x 3-S	3	3	1/8	3/8	32	5/8	1/2	BUB-500-S	EF	8,150
3/4-16 Threads										
TSH-0750 x 2-S	2	2	1/8	3/8	32	5/8	1/2	BUB-500-S	EF	8,150
TSH-0750 x 2.5-S	2 1/2	2 1/2	1/8	3/8	32	5/8	1/2	BUB-500-S	EF	8,150
TSH-0750 x 3-S	3	2	1/8	3/8	32	5/8	1/2	BUB-500-S	EF	8,150
TSHF-0750 x 3-S	3	3	1/8	3/8	32	5/8	1/2	BUB-500-S	EF	8,150
1-8 Threads										
TSH-1108 x 2-S	2	2	1/8	1/2	40	3/4	5/8	BUB-600-S	FINE	14,757
TSH-1108 x 3-S	3	3	1/8	1/2	40	3/4	5/8	BUB-600-S	FINE	14,757
TSH-1108 x 4-S	4	2 1/2	1/8	1/2	40	3/4	5/8	BUB-600-S	FINE	14,757
TSHF-1108 x 4-S	4	4	1/8	1/2	40	3/4	5/8	BUB-600-S	FINE	14,757
1-14 Threads										
TSH-1114 x 2-S	2	2	1/8	5/8	32	3/4	3/4	BUB-700-S	FINE	17,210
TSH-1114 x 3-S	3	3	1/8	5/8	32	3/4	3/4	BUB-700-S	FINE	17,210
TSH-1114 x 4-S	4	2 1/2	1/8	5/8	32	3/4	3/4	BUB-700-S	FINE	17,210
TSHF-1114 x 4-S	4	4	1/8	5/8	32	3/4	3/4	BUB-700-S	FINE	17,210

Socket Head Style Steel Ball – Flat – Inch

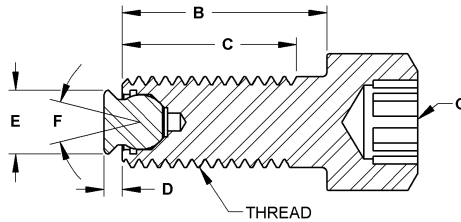
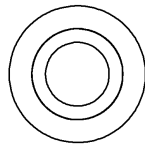

These thrust screw assemblies allow straight line static load thrust without transmitting torsional or radial force on to the work piece. The free floating ball design allows the thread to continue to rotate while the ball remains stationary against the surface. Ideal for irregular shaped or contoured work pieces. The housing is made from alloy steel, heat treated to Rc 43/46 with a black oxide finish. The replaceable ball is held in place with a viton O-ring which keeps contaminants out and allows the ball to swivel. The ball is made from M-2 high speed steel and heat treated to Rc 60/62. Replacement balls can be ordered separately.

INCH									
Part Number	B Shank Length	C Thread Length	D Stand Off	E Contact Dia.	F Degree Swivel	G Int Hex	Ball Dia	Ball Only Part Number	Load Rating Lbs.
1/4-20 Threads									
TSH-0250-FC	3/4	3/4	5/64	9/64	32	3/16	1/8	BUB-125-FC	---
TSH-0251-FC	1	1	5/64	9/64	32	3/16	1/8	BUB-125-FC	---
TSH-0251 x 1.5-FC	1 1/2	1	5/64	9/64	32	3/16	1/8	BUB-125-FC	---
TSHF-0251 x 1.5-FC	1 1/2	1 1/2	5/64	9/64	32	3/16	1/8	BUB-125-FC	---
1/4-28 Threads									
TSH-0280-FC	3/4	3/4	5/64	9/64	32	3/16	1/8	BUB-125-FC	---
TSH-0281-FC	1	1	5/64	9/64	32	3/16	1/8	BUB-125-FC	---
TSH-0281 x 1.5-FC	1 1/2	1	5/64	9/64	32	3/16	1/8	BUB-125-FC	---
TSHF-0281 x 1.5-FC	1 1/2	1 1/2	5/64	9/64	32	3/16	1/8	BUB-125-FC	---
5/16-18 Threads									
TSH-0310-FC	3/4	3/4	3/32	13/64	28	1/4	5/32	BUB-156-FC	---
TSH-0312-FC	1	1	3/32	13/64	28	1/4	5/32	BUB-156-FC	---
TSH-0312 x 1.25-FC	1 1/4	1 1/4	3/32	13/64	28	1/4	5/32	BUB-156-FC	---
TSH-0312 x 1.75-FC	1 3/4	1 1/8	3/32	13/64	28	1/4	5/32	BUB-156-FC	---
TSHF-0312 x 1.75-FC	1 3/4	1 3/4	3/32	13/64	28	1/4	5/32	BUB-156-FC	---
TSH-0312 x 2-FC	2	1 1/8	3/32	13/64	28	1/4	5/32	BUB-156-FC	---
TSHF-0312 x 2-FC	2	2	3/32	13/64	28	1/4	5/32	BUB-156-FC	---
5/16-24 Threads									
TSH-0320-FC	3/4	3/4	3/32	13/64	28	1/4	5/32	BUB-156-FC	---
TSH-0321-FC	1	1	3/32	13/64	28	1/4	5/32	BUB-156-FC	---
TSH-0321 x 1.25-FC	1 1/4	1 1/4	3/32	13/64	28	1/4	5/32	BUB-156-FC	---
TSH-0321 x 1.75-FC	1 3/4	1 1/8	3/32	13/64	28	1/4	5/32	BUB-156-FC	---
TSHF-0321 x 1.75-FC	1 3/4	1 3/4	3/32	13/64	28	1/4	5/32	BUB-156-FC	---
TSH-0321 x 2-FC	2	1 1/8	3/32	13/64	28	1/4	5/32	BUB-156-FC	---
TSHF-0321 x 2-FC	2	2	3/32	13/64	28	1/4	5/32	BUB-156-FC	---
3/8-16 Threads									
TSH-0375-FC	1	1	3/32	1/4	28	5/16	3/16	BUB-187-FC	1,763
TSH-0375 x 1.5-FC	1 1/2	1 1/2	3/32	1/4	28	5/16	3/16	BUB-187-FC	1,763
TSH-0375 x 2-FC	2	1 1/2	3/32	1/4	28	5/16	3/16	BUB-187-FC	1,763
TSHF-0375 x 2-FC	2	2	3/32	1/4	28	5/16	3/16	BUB-187-FC	1,763
TSH-0375 x 2.5-FC	2 1/2	1 1/2	3/32	1/4	28	5/16	3/16	BUB-187-FC	1,763
TSHF-0375 x 2.5-FC	2 1/2	2 1/2	3/32	1/4	28	5/16	3/16	BUB-187-FC	1,763
3/8-24 Threads									
TSH-0231-FC	1	1	3/32	1/4	28	5/16	3/16	BUB-187-FC	1,763
TSH-0231 x 1.5-FC	1 1/2	1 1/2	3/32	1/4	28	5/16	3/16	BUB-187-FC	1,763
TSH-0231 x 2-FC	2	1 3/8	3/32	1/4	28	5/16	3/16	BUB-187-FC	1,763
TSHF-0231 x 2-FC	2	2	3/32	1/4	28	5/16	3/16	BUB-187-FC	1,763
TSH-0231 x 2.5-FC	2 1/2	1 3/8	3/32	1/4	28	5/16	3/16	BUB-187-FC	1,763
TSHF-0231 x 2.5-FC	2 1/2	2 1/2	3/32	1/4	28	5/16	3/16	BUB-187-FC	1,763

Socket Head Style Steel Ball – Flat – Inch (continued)

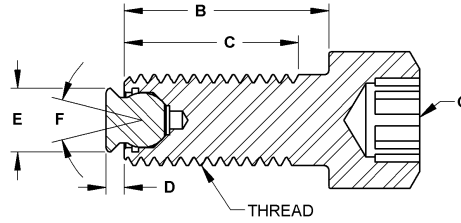
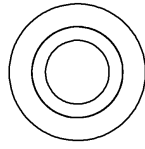

INCH (CONTINUED)

Part Number	B Shank Length	C Thread Length	D Stand Off	E Contact Dia.	F Degree Swivel	G Int Hex	Ball Dia	Ball Only Part Number	Load Rating Lbs.
1/2-13 Threads									
TSH-0510 x 1.25-FC	1 1/4	1 1/4	1/8	11/32	26	3/8	9/32	BUB-200-FC	4,527
TSH-0510 x 1.5-FC	1 1/2	1 1/2	1/8	11/32	26	3/8	9/32	BUB-200-FC	4,527
TSH-0510 x 2-FC	2	2	1/8	11/32	26	3/8	9/32	BUB-200-FC	4,527
TSH-0510 x 2.5-FC	2 1/2	1 1/2	1/8	11/32	26	3/8	9/32	BUB-200-FC	4,527
TSHF-0510 x 2.5-FC	2 1/2	2 1/2	1/8	11/32	26	3/8	9/32	BUB-200-FC	4,527
TSH-0510 x 3-FC	3	1 1/2	1/8	11/32	26	3/8	9/32	BUB-200-FC	4,527
TSHF-0510 x 3-FC	3	3	1/8	11/32	26	3/8	9/32	BUB-200-FC	4,527
1/2-20 Threads									
TSH-0500 x 1.25-FC	1 1/4	1 1/4	1/8	11/32	26	3/8	9/32	BUB-200-FC	4,527
TSH-0500 x 1.5-FC	1 1/2	1 1/2	1/8	11/32	26	3/8	9/32	BUB-200-FC	4,527
TSH-0500 x 2-FC	2	2	1/8	11/32	26	3/8	9/32	BUB-200-FC	4,527
TSH-0500 x 2.5-FC	2 1/2	1 1/2	1/8	11/32	26	3/8	9/32	BUB-200-FC	4,527
TSHF-0500 x 2.5-FC	2 1/2	2 1/2	1/8	11/32	26	3/8	9/32	BUB-200-FC	4,527
TSH-0500 x 3-FC	3	1 1/2	1/8	11/32	26	3/8	9/32	BUB-200-FC	4,527
TSHF-0500 x 3-FC	3	3	1/8	11/32	26	3/8	9/32	BUB-200-FC	4,527
5/8-11 Threads									
TSH-0625-FC	1 1/2	1 1/2	1/8	7/16	28	1/2	3/8	BUB-300-FC	6,131
TSH-0625 x 2-FC	2	2	1/8	7/16	28	1/2	3/8	BUB-300-FC	6,131
TSH-0625 x 2.5-FC	2 1/2	1 3/4	1/8	7/16	28	1/2	3/8	BUB-300-FC	6,131
TSHF-0625 x 2.5-FC	2 1/2	2 1/2	1/8	7/16	28	1/2	3/8	BUB-300-FC	6,131
TSH-0625 x 3-FC	3	1 3/4	1/8	7/16	28	1/2	3/8	BUB-300-FC	6,131
TSHF-0625x3-FC	3	3	1/8	7/16	28	1/2	3/8	BUB-300-FC	6,131
5/8-18 Threads									
TSH-0620-FC	1 1/2	1 1/2	1/8	7/16	28	1/2	3/8	BUB-300-FC	6,131
TSH-0620 x 2-FC	2	2	1/8	7/16	28	1/2	3/8	BUB-300-FC	6,131
TSH-0620 x 2.5-FC	2 1/2	1 3/4	1/8	7/16	28	1/2	3/8	BUB-300-FC	6,131
TSHF-0620 x 2.5-FC	2 1/2	2 1/2	1/8	7/16	28	1/2	3/8	BUB-300-FC	6,131
TSH-0620 x 3-FC	3	1 3/4	1/8	7/16	28	1/2	3/8	BUB-300-FC	6,131
TSHF-0620 x 3-FC	3	3	1/8	7/16	28	1/2	3/8	BUB-300-FC	6,131
3/4-10 Threads									
TSH-0755 x 2-FC	2	2	3/16	33/64	22	5/8	1/2	BUB-500-FC	8,150
TSH-0755 x 2.5-FC	2 1/2	2 1/2	3/16	33/64	22	5/8	1/2	BUB-500-FC	8,150
TSH-0755 x 3-FC	3	2	3/16	33/64	22	5/8	1/2	BUB-500-FC	8,150
TSHF-0755 x 3-FC	3	3	3/16	33/64	22	5/8	1/2	BUB-500-FC	8,150
3/4-16 Threads									
TSH-0750 x 2-FC	2	2	3/16	33/64	22	5/8	1/2	BUB-500-FC	8,150
TSH-0750 x 2.5-FC	2 1/2	2 1/2	3/16	33/64	22	5/8	1/2	BUB-500-FC	8,150
TSH-0750 x 3-FC	3	2	3/16	33/64	22	5/8	1/2	BUB-500-FC	8,150
TSHF-0750 x 3-FC	3	3	3/16	33/64	22	5/8	1/2	BUB-500-FC	8,150
1-8 Threads									
TSH-1108 x 2-FC	2	2	1/4	11/16	24	3/4	5/8	BUB-600-FC	14,757
TSH-1108 x 3-FC	3	3	1/4	11/16	24	3/4	5/8	BUB-600-FC	14,757
TSH-1108 x 4-FC	4	2 1/2	1/4	11/16	24	3/4	5/8	BUB-600-FC	14,757
TSHF-1108 x 4-FC	4	4	1/4	11/16	24	3/4	5/8	BUB-600-FC	14,757
1-14 Threads									
TSH-1114 x 2-FC	2	2	1/4	49/64	24	3/4	3/4	BUB-700-FC	17,210
TSH-1114 x 3-FC	3	3	1/4	49/64	24	3/4	3/4	BUB-700-FC	17,210
TSH-1114 x 4-FC	4	2 1/2	1/4	49/64	24	3/4	3/4	BUB-700-FC	17,210
TSHF-1114 x 4-FC	4	4	1/4	49/64	24	3/4	3/4	BUB-700-FC	17,210

Socket Head Style Stainless Steel Ball – Round – Inch

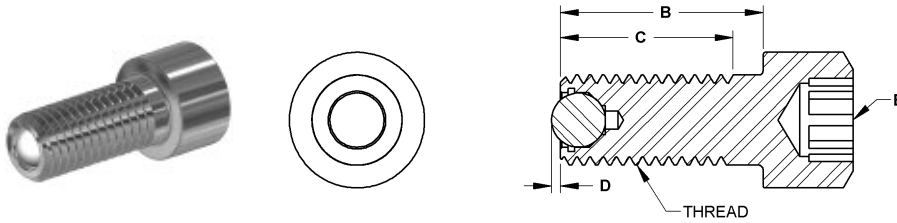

These thrust screw assemblies allow straight line static load thrust without transmitting torsional or radial force on to the work piece. The free floating ball design allows the thread to continue to rotate while the ball remains stationary against the surface. Ideal for irregular shaped or contoured work pieces. The housing is made from alloy steel, heat treated to Rc 43/46 with a black oxide finish. The replaceable ball is held in place with a viton O-ring which keeps contaminants out and allows the ball to swivel. The ball is made from 440c stainless steel and heat treated to Rc 55/60. Replacement balls can be ordered separately.

INCH							
Part Number	B Shank Length	C Thread Length	D Stand Off	E Int Hex	Ball Dia	Ball Only Part Number	Load Rating Lbs.
5/16-18 Threads							
TSH-0310-SB	3/4	3/4	.026	1/4	5/32	BUB-156-SB	---
TSH-0312-SB	1	1	.026	1/4	5/32	BUB-156-SB	---
TSH-0312 x 1.25-SB	1 1/4	1 1/4	.026	1/4	5/32	BUB-156-SB	---
TSH-0312 x 1.75-SB	1 3/4	1 1/8	.026	1/4	5/32	BUB-156-SB	---
TSHF-0312 x 1.75-SB	1 3/4	1 3/4	.026	1/4	5/32	BUB-156-SB	---
TSH-0312 x 2-SB	2	1 1/8	.026	1/4	5/32	BUB-156-SB	---
TSHF-0312 x 2-SB	2	2	.026	1/4	5/32	BUB-156-SB	---
5/16-24 Threads							
TSH-0320-SB	3/4	3/4	.026	1/4	5/32	BUB-156-SB	---
TSH-0321-SB	1	1	.026	1/4	5/32	BUB-156-SB	---
TSH-0321 x 1.25-SB	1 1/4	1 1/4	.026	1/4	5/32	BUB-156-SB	---
TSH-0321 x 1.75-SB	1 3/4	1 1/8	.026	1/4	5/32	BUB-156-SB	---
TSHF-0321 x 1.75-SB	1 3/4	1 3/4	.026	1/4	5/32	BUB-156-SB	---
TSH-0321 x 2-SB	2	1 1/8	.026	1/4	5/32	BUB-156-SB	---
TSHF-0321 x 2-SB	2	2	.026	1/4	5/32	BUB-156-SB	---
3/8-16 Threads							
TSH-0375-SB	1	1	.024	5/16	3/16	BUB-187-SB	1,763
TSH-0375 x 1.5-SB	1 1/2	1 1/2	.024	5/16	3/16	BUB-187-SB	1,763
TSH-0375 x 2-SB	2	1 1/2	.024	5/16	3/16	BUB-187-SB	1,763
TSHF-0375 x 2-SB	2	2	.024	5/16	3/16	BUB-187-SB	1,763
TSH-0375 x 2.5-SB	2 1/2	1 1/2	.024	5/16	3/16	BUB-187-SB	1,763
TSHF-0375 x 2.5-SB	2 1/2	2 1/2	.024	5/16	3/16	BUB-187-SB	1,763
3/8-24 Threads							
TSH-0231-SB	1	1	.024	5/16	3/16	BUB-187-SB	1,763
TSH-0231 x 1.5-SB	1 1/2	1 1/2	.024	5/16	3/16	BUB-187-SB	1,763
TSH-0231 x 2-SB	2	1 3/8	.024	5/16	3/16	BUB-187-SB	1,763
TSHF-0231 x 2-SB	2	2	.024	5/16	3/16	BUB-187-SB	1,763
TSH-0231 x 2.5-SB	2 1/2	1 3/8	.024	5/16	3/16	BUB-187-SB	1,763
TSHF-0231 x 2.5-SB	2 1/2	2 1/2	.024	5/16	3/16	BUB-187-SB	1,763
1/2-13 Threads							
TSH-0510 x 1.25-SB	1 1/4	1 1/4	.063	3/8	9/32	BUB-200-SB	4,527
TSH-0510 x 1.5-SB	1 1/2	1 1/2	.063	3/8	9/32	BUB-200-SB	4,527
TSH-0510 x 2-SB	2	2	.063	3/8	9/32	BUB-200-SB	4,527
TSH-0510 x 2.5-SB	2 1/2	1 1/2	.063	3/8	9/32	BUB-200-SB	4,527
TSHF-0510 x 2.5-SB	2 1/2	2 1/2	.063	3/8	9/32	BUB-200-SB	4,527
TSH-0510 x 3-SB	3	1 1/2	.063	3/8	9/32	BUB-200-SB	4,527
TSHF-0510 x 3-SB	3	3	.063	3/8	9/32	BUB-200-SB	4,527
1/2-20 Threads							
TSH-0500 x 1.25-SB	1 1/4	1 1/4	.063	3/8	9/32	BUB-200-SB	4,527
TSH-0500 x 1.5-SB	1 1/2	1 1/2	.063	3/8	9/32	BUB-200-SB	4,527
TSH-0500 x 2-SB	2	2	.063	3/8	9/32	BUB-200-SB	4,527
TSH-0500 x 2.5-SB	2 1/2	1 1/2	.063	3/8	9/32	BUB-200-SB	4,527
TSHF-0500 x 2.5-SB	2 1/2	2 1/2	.063	3/8	9/32	BUB-200-SB	4,527
TSH-0500 x 3-SB	3	1 1/2	.063	3/8	9/32	BUB-200-SB	4,527
TSHF-0500 x 3-SB	3	3	.063	3/8	9/32	BUB-200-SB	4,527

Socket Head Style Stainless Steel Ball – Round – Inch (continued)

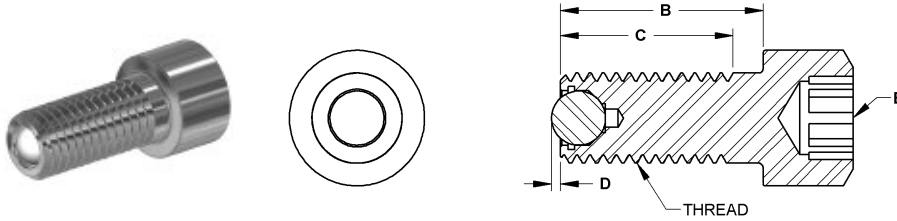

INCH (CONTINUED)

Part Number	B Shank Length	C Thread Length	D Stand Off	E Int Hex	Ball Dia	Ball Only Part Number	Load Rating Lbs.
5/8-11 Threads							
TSH-0625-SB	1 1/2	1 1/2	.063	1/2	3/8	BUB-300-SB	6,131
TSH-0625 x 2-SB	2	2	.063	1/2	3/8	BUB-300-SB	6,131
TSH-0625 x 2.5-SB	2 1/2	1 3/4	.063	1/2	3/8	BUB-300-SB	6,131
TSHF-0625 x 2.5-SB	2 1/2	2 1/2	.063	1/2	3/8	BUB-300-SB	6,131
TSH-0625 x 3-SB	3	1 3/4	.063	1/2	3/8	BUB-300-SB	6,131
TSHF-0625 x 3-SB	3	3	.063	1/2	3/8	BUB-300-SB	6,131
5/8-18 Threads							
TSH-0620-SB	1 1/2	1 1/2	.063	1/2	3/8	BUB-300-SB	6,131
TSH-0620 x 2-SB	2	2	.063	1/2	3/8	BUB-300-SB	6,131
TSH-0620 x 2.5-SB	2 1/2	1 3/4	.063	1/2	3/8	BUB-300-SB	6,131
TSHF-0620 x 2.5-SB	2 1/2	2 1/2	.063	1/2	3/8	BUB-300-SB	6,131
TSH-0620 x 3-SB	3	1 3/4	.063	1/2	3/8	BUB-300-SB	6,131
TSHF-0620 x 3-SB	3	3	.063	1/2	3/8	BUB-300-SB	6,131
3/4-10 Threads							
TSH-0755 x 2-SB	2	2	.107	5/8	1/2	BUB-500-SB	8,150
TSH-0755 x 2.5-SB	2 1/2	2 1/2	.107	5/8	1/2	BUB-500-SB	8,150
TSH-0755 x 3-SB	3	2	.107	5/8	1/2	BUB-500-SB	8,150
TSHF-0755 x 3-SB	3	3	.107	5/8	1/2	BUB-500-SB	8,150
3/4-16 Threads							
TSH-0750 x 2-SB	2	2	.107	5/8	1/2	BUB-500-SB	8,150
TSH-0750 x 2.5-SB	2 1/2	2 1/2	.107	5/8	1/2	BUB-500-SB	8,150
TSH-0750 x 3-SB	3	2	.107	5/8	1/2	BUB-500-SB	8,150
TSHF-0750 x 3-SB	3	3	.107	5/8	1/2	BUB-500-SB	8,150
1-8 Threads							
TSH-1108 x 2-SB	2	2	.175	3/4	5/8	BUB-600-SB	14,757
TSH-1108 x 3-SB	3	3	.175	3/4	5/8	BUB-600-SB	14,757
TSH-1108 x 4-SB	4	2 1/2	.175	3/4	5/8	BUB-600-SB	14,757
TSHF-1108 x 4-SB	4	4	.175	3/4	5/8	BUB-600-SB	14,757
1-14 Threads							
TSH-1114 x 2-SB	2	2	.208	3/4	3/4	BUB-700-SB	17,210
TSH-1114 x 3-SB	3	3	.208	3/4	3/4	BUB-700-SB	17,210
TSH-1114 x 4-SB	4	2 1/2	.208	3/4	3/4	BUB-700-SB	17,210
TSHF-1114 x 4-SB	4	4	.208	3/4	3/4	BUB-700-SB	17,210

Socket Head Style Delrin Ball – Flat – Inch

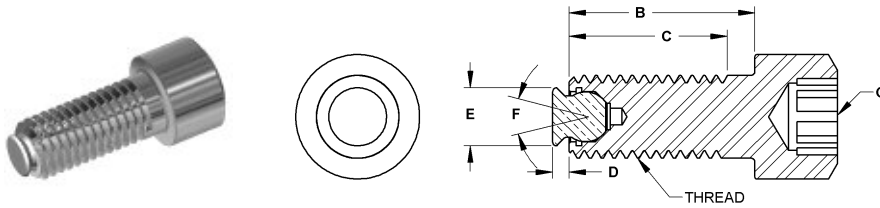

These thrust screw assemblies allow straight line static load thrust without transmitting torsional or radial force on to the work piece. The free floating ball design allows the thread to continue to rotate while the ball remains stationary against the surface. Ideal for irregular shaped or contoured work pieces. The housing is made from alloy steel, heat treated to Rc 43/46 with a black oxide finish. The replaceable ball is held in place with a viton O-ring which keeps contaminants out and allows the ball to swivel. The ball is made from non-marring white delrin and ground flat. Replacement balls can be ordered separately.

INCH								
Part Number	B Shank Length	C Thread Length	D Stand Off	E Contact Dia.	F Degree Swivel	G Int Hex	Ball Dia	Ball Only Part Number
1/4-20 Threads								
TSH-0250-DC	3/4	3/4	5/64	9/64	32	3/16	1/8	BUB-125-DC
TSH-0251-DC	1	1	5/64	9/64	32	3/16	1/8	BUB-125-DC
TSH-0251 x 1.5-DC	1 1/2	1	5/64	9/64	32	3/16	1/8	BUB-125-DC
TSHF-0251 x 1.5-DC	1 1/2	1 1/2	5/64	9/64	32	3/16	1/8	BUB-125-DC
1/4-28 Threads								
TSH-0280-DC	3/4	3/4	5/64	9/64	32	3/16	1/8	BUB-125-DC
TSH-0281-DC	1	1	5/64	9/64	32	3/16	1/8	BUB-125-DC
TSH-0281 x 1.5-DC	1 1/2	1	5/64	9/64	32	3/16	1/8	BUB-125-DC
TSHF-0281 x 1.5-DC	1 1/2	1 1/2	5/64	9/64	32	3/16	1/8	BUB-125-DC
5/16-18 Threads								
TSH-0310-DC	3/4	3/4	3/32	13/64	28	1/4	5/32	BUB-156-DC
TSH-0312-DC	1	1	3/32	13/64	28	1/4	5/32	BUB-156-DC
TSH-0312 x 1.25-DC	1 1/4	1 1/4	3/32	13/64	28	1/4	5/32	BUB-156-DC
TSH-0312 x 1.75-DC	1 3/4	1 1/8	3/32	13/64	28	1/4	5/32	BUB-156-DC
TSHF-0312 x 1.75-DC	1 3/4	1 3/4	3/32	13/64	28	1/4	5/32	BUB-156-DC
TSH-0312 x 2-DC	2	1 1/8	3/32	13/64	28	1/4	5/32	BUB-156-DC
TSHF-0312 x 2-DC	2	2	3/32	13/64	28	1/4	5/32	BUB-156-DC
5/16-24 Threads								
TSH-0320-DC	3/4	3/4	3/32	13/64	28	1/4	5/32	BUB-156-DC
TSH-0321-DC	1	1	3/32	13/64	28	1/4	5/32	BUB-156-DC
TSH-0321 x 1.25-DC	1 1/4	1 1/4	3/32	13/64	28	1/4	5/32	BUB-156-DC
TSH-0321 x 1.75-DC	1 3/4	1 1/8	3/32	13/64	28	1/4	5/32	BUB-156-DC
TSHF-0321 x 1.75-DC	1 3/4	1 3/4	3/32	13/64	28	1/4	5/32	BUB-156-DC
TSH-0321 x 2-DC	2	1 1/8	3/32	13/64	28	1/4	5/32	BUB-156-DC
TSHF-0321 x 2-DC	2	2	3/32	13/64	28	1/4	5/32	BUB-156-DC
3/8-16 Threads								
TSH-0375-DC	1	1	3/32	1/4	28	5/16	3/16	BUB-187-DC
TSH-0375 x 1.5-DC	1 1/2	1 1/2	3/32	1/4	28	5/16	3/16	BUB-187-DC
TSH-0375 x 2-DC	2	1 1/2	3/32	1/4	28	5/16	3/16	BUB-187-DC
TSHF-0375 x 2-DC	2	2	3/32	1/4	28	5/16	3/16	BUB-187-DC
TSH-0375 x 2.5-DC	2 1/2	1 1/2	3/32	1/4	28	5/16	3/16	BUB-187-DC
TSHF-0375 x 2.5-DC	2 1/2	2 1/2	3/32	1/4	28	5/16	3/16	BUB-187-DC
3/8-24 Threads								
TSH-0231-DC	1	1	3/32	1/4	28	5/16	3/16	BUB-187-DC
TSH-0231 x 1.5-DC	1 1/2	1 1/2	3/32	1/4	28	5/16	3/16	BUB-187-DC
TSH-0231 x 2-DC	2	1 3/8	3/32	1/4	28	5/16	3/16	BUB-187-DC
TSHF-0231 x 2-DC	2	2	3/32	1/4	28	5/16	3/16	BUB-187-DC
TSH-0231 x 2.5-DC	2 1/2	1 3/8	3/32	1/4	28	5/16	3/16	BUB-187-DC
TSHF-0231 x 2.5-DC	2 1/2	2 1/2	3/32	1/4	28	5/16	3/16	BUB-187-DC

Socket Head Style Delrin Ball – Flat – Inch (continued)

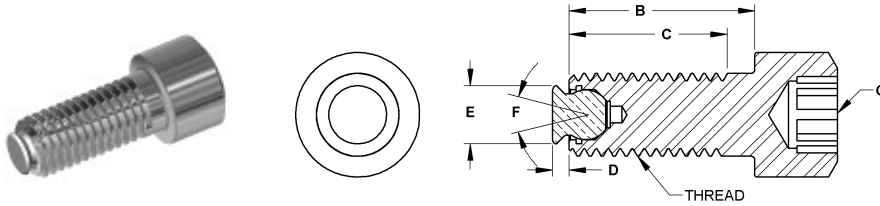

INCH (CONTINUED)

Part Number	B Shank Length	C Thread Length	D Stand Off	E Contact Dia.	F Degree Swivel	G Int Hex	Ball Dia	Ball Only Part Number
1/2-13 Threads								
TSH-0510 x 1.25-DC	1 1/4	1 1/4	1/8	11/32	28	3/8	9/32	BUB-200-DC
TSH-0510 x 1.5-DC	1 1/2	1 1/2	1/8	11/32	28	3/8	9/32	BUB-200-DC
TSH-0510 x 2-DC	2	2	1/8	11/32	28	3/8	9/32	BUB-200-DC
TSH-0510 x 2.5-DC	2 1/2	1 1/2	1/8	11/32	28	3/8	9/32	BUB-200-DC
TSHF-0510 x 2.5-DC	2 1/2	2 1/2	1/8	11/32	28	3/8	9/32	BUB-200-DC
TSH-0510 x 3-DC	3	1 1/2	1/8	11/32	28	3/8	9/32	BUB-200-DC
TSHF-0510 x 3-DC	3	3	1/8	11/32	28	3/8	9/32	BUB-200-DC
1/2-20 Threads								
TSH-0500 x 1.25-DC	1 1/4	1 1/4	1/8	11/32	28	3/8	9/32	BUB-200-DC
TSH-0500 x 1.5-DC	1 1/2	1 1/2	1/8	11/32	28	3/8	9/32	BUB-200-DC
TSH-0500 x 2-DC	2	2	1/8	11/32	28	3/8	9/32	BUB-200-DC
TSH-0500 x 2.5-DC	2 1/2	1 1/2	1/8	11/32	28	3/8	9/32	BUB-200-DC
TSHF-0500 x 2.5-DC	2 1/2	2 1/2	1/8	11/32	28	3/8	9/32	BUB-200-DC
TSH-0500 x 3-DC	3	1 1/2	1/8	11/32	28	3/8	9/32	BUB-200-DC
TSHF-0500 x 3-DC	3	3	1/8	11/32	28	3/8	9/32	BUB-200-DC
5/8-11 Threads								
TSH-0625-DC	1 1/2	1 1/2	1/8	7/16	28	1/2	3/8	BUB-300-DC
TSH-0625 x 2-DC	2	1 3/4	1/8	7/16	28	1/2	3/8	BUB-300-DC
TSH-0625 x 2.5-DC	2 1/2	1 3/4	1/8	7/16	28	1/2	3/8	BUB-300-DC
TSHF-0625 x 2.5-DC	2 1/2	2 1/2	1/8	7/16	28	1/2	3/8	BUB-300-DC
TSH-0625 x 3-DC	3	1 3/4	1/8	7/16	28	1/2	3/8	BUB-300-DC
TSHF-0625 x 3-DC	3	3	1/8	7/16	28	1/2	3/8	BUB-300-DC
5/8-18 Threads								
TSH-0620-DC	1 1/2	1 1/2	1/8	7/16	28	1/2	3/8	BUB-300-DC
TSH-0620 x 2-DC	2	2	1/8	7/16	28	1/2	3/8	BUB-300-DC
TSH-0620 x 2.5-DC	2 1/2	1 3/4	1/8	7/16	28	1/2	3/8	BUB-300-DC
TSHF-0620 x 2.5-DC	2 1/2	2 1/2	1/8	7/16	28	1/2	3/8	BUB-300-DC
TSH-0620 x 3-DC	3	1 3/4	1/8	7/16	28	1/2	3/8	BUB-300-DC
TSHF-0620 x 3-DC	3	3	1/8	7/16	28	1/2	3/8	BUB-300-DC
3/4-10 Threads								
TSH-0755 x 2-DC	2	2	3/16	33/64	32	5/8	1/2	BUB-500-DC
TSH-0755 x 2.5-DC	2 1/2	2 1/2	3/16	33/64	32	5/8	1/2	BUB-500-DC
TSH-0755 x 3-DC	3	2	3/16	33/64	32	5/8	1/2	BUB-500-DC
TSHF-0755 x 3-DC	3	3	3/16	33/64	32	5/8	1/2	BUB-500-DC
3/4-16 Threads								
TSH-0750 x 2-DC	2	2	3/16	33/64	32	5/8	1/2	BUB-500-DC
TSH-0750 x 2.5-DC	2 1/2	2 1/2	3/16	33/64	32	5/8	1/2	BUB-500-DC
TSH-0750 x 3-DC	3	2	3/16	33/64	32	5/8	1/2	BUB-500-DC
TSHF-0750 x 3-DC	3	3	3/16	33/64	32	5/8	1/2	BUB-500-DC
1-8 Threads								
TSH-1108 x 2-DC	2	2	1/4	11/16	40	3/4	5/8	BUB-600-DC
TSH-1108 x 3-DC	3	3	1/4	11/16	40	3/4	5/8	BUB-600-DC
TSH-1108 x 4-DC	4	2 1/2	1/4	11/16	40	3/4	5/8	BUB-600-DC
TSHF-1108 x 4-DC	4	4	1/4	11/16	40	3/4	5/8	BUB-600-DC
1-14 Threads								
TSH-1114 x 2-DC	2	2	1/4	49/64	32	3/4	3/4	BUB-700-DC
TSH-1114 x 3-DC	3	3	1/4	49/64	32	3/4	3/4	BUB-700-DC
TSH-1114 x 4-DC	4	2 1/2	1/4	49/64	32	3/4	3/4	BUB-700-DC
TSHF-1114 x 4-DC	4	4	1/4	49/64	32	3/4	3/4	BUB-700-DC

Socket Head Style Delrin Ball – Round – Inch

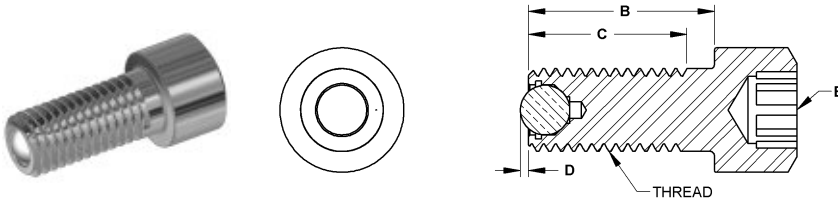

These thrust screw assemblies allow straight line static load thrust without transmitting torsional or radial force on to the work piece. The free floating ball design allows the thread to continue to rotate while the ball remains stationary against the surface. Ideal for irregular shaped or contoured work pieces. The housing is made from alloy steel, heat treated to Rc 43/46 with a black oxide finish. The replaceable ball is held in place with a viton O-ring which keeps contaminants out and allows the ball to swivel. The ball is made from non-marring white delrin. Replacement balls can be ordered separately.

INCH													
Part Number	B Shank Length	C Thread Length	D Stand Off	E Int Hex	Ball Dia	Ball Only Part Number	Part Number	B Shank Length	C Thread Length	D Stand Off	E Int Hex	Ball Dia	Ball Only Part Number
5/16-18 Threads							5/8-11 Threads						
TSH-0310-DB	3/4	3/4	.026	1/4	5/32	BUB-156-DB	TSH-0625-DB	1 1/2	1 1/2	.063	1/2	3/8	BUB-300-DB
TSH-0312-DB	1	1	.026	1/4	5/32	BUB-156-DB	TSH-0625 x 2-DB	2	2	.063	1/2	3/8	BUB-300-DB
TSH-0312 x 1.25-DB	1 1/4	1 1/4	.026	1/4	5/32	BUB-156-DB	TSH-0625 x 2.5-DB	2 1/2	1 3/4	.063	1/2	3/8	BUB-300-DB
TSH-0312 x 1.75-DB	1 3/4	1 1/8	.026	1/4	5/32	BUB-156-DB	TSHF-0625 x 2.5-DB	2 1/2	2 1/2	.063	1/2	3/8	BUB-300-DB
TSHF-0312 x 1.75-DB	1 3/4	1 3/4	.026	1/4	5/32	BUB-156-DB	TSH-0625 x 3-DB	3	1 3/4	.063	1/2	3/8	BUB-300-DB
TSH-0312 x 2-DB	2	1 1/8	.026	1/4	5/32	BUB-156-DB	TSHF-0625 x 3-DB	3	3	.063	1/2	3/8	BUB-300-DB
TSHF-0312 x 2-DB	2	2	.026	1/4	5/32	BUB-156-DB	5/8-18 Threads						
5/16-24 Threads							TSH-0620-DB	1 1/2	1 1/2	.063	1/2	3/8	BUB-300-DB
TSH-0320-DB	3/4	3/4	.026	1/4	5/32	BUB-156-DB	TSH-0620 x 2-DB	2	2	.063	1/2	3/8	BUB-300-DB
TSH-0321-DB	1	1	.026	1/4	5/32	BUB-156-DB	TSH-0620 x 2.5-DB	2 1/2	1 3/4	.063	1/2	3/8	BUB-300-DB
TSH-0321 x 1.25-DB	1 1/4	1 1/4	.026	1/4	5/32	BUB-156-DB	TSHF-0620 x 2.5-DB	2 1/2	2 1/2	.063	1/2	3/8	BUB-300-DB
TSH-0321 x 1.75-DB	1 3/4	1 1/8	.026	1/4	5/32	BUB-156-DB	TSH-0620 x 3-DB	3	1 3/4	.063	1/2	3/8	BUB-300-DB
TSHF-0321 x 1.75-DB	1 3/4	1 3/4	.026	1/4	5/32	BUB-156-DB	TSHF-0620 x 3-DB	3	3	.063	1/2	3/8	BUB-300-DB
TSH-0321 x 2-DB	2	1 1/8	.026	1/4	5/32	BUB-156-DB	3/4-10 Threads						
TSHF-0321 x 2-DB	2	2	.026	1/4	5/32	BUB-156-DB	TSH-0755 x 2-DB	2	2	.107	5/8	1/2	BUB-500-DB
3/8-16 Threads							TSH-0755 x 2.5-DB	2 1/2	2 1/2	.107	5/8	1/2	BUB-500-DB
TSH-0375-DB	1	1	.024	5/16	3/16	BUB-187-DB	TSH-0755 x 3-DB	3	2	.107	5/8	1/2	BUB-500-DB
TSH-0375 x 1.5-DB	1 1/2	1 1/2	.024	5/16	3/16	BUB-187-DB	TSHF-0755 x 3-DB	3	3	.107	5/8	1/2	BUB-500-DB
TSH-0375 x 2-DB	2	1 1/2	.024	5/16	3/16	BUB-187-DB	3/4-16 Threads						
TSHF-0375 x 2-DB	2	2	.024	5/16	3/16	BUB-187-DB	TSH-0750 x 2-DB	2	2	.107	5/8	1/2	BUB-500-DB
TSH-0375 x 2.5-DB	2 1/2	1 1/2	.024	5/16	3/16	BUB-187-DB	TSH-0750 x 2.5-DB	2 1/2	2 1/2	.107	5/8	1/2	BUB-500-DB
TSHF-0375 x 2.5-DB	2 1/2	2 1/2	.024	5/16	3/16	BUB-187-DB	TSH-0750 x 3-DB	3	2	.107	5/8	1/2	BUB-500-DB
3/8-24 Threads							TSHF-0750 x 3-DB	3	3	.107	5/8	1/2	BUB-500-DB
TSH-0231-DB	1	1	.024	5/16	3/16	BUB-187-DB	1-8 Threads						
TSH-0231 x 1.5-DB	1 1/2	1 1/2	.024	5/16	3/16	BUB-187-DB	TSH-1108 x 2-DB	2	2	.175	3/4	5/8	BUB-600-DB
TSH-0231 x 2-DB	2	1 3/8	.024	5/16	3/16	BUB-187-DB	TSH-1108 x 3-DB	3	3	.175	3/4	5/8	BUB-600-DB
TSHF-0231 x 2-DB	2	2	.024	5/16	3/16	BUB-187-DB	TSH-1108 x 4-DB	4	2 1/2	.175	3/4	5/8	BUB-600-DB
TSH-0231 x 2.5-DB	2 1/2	1 3/8	.024	5/16	3/16	BUB-187-DB	TSHF-1108 x 4-DB	4	4	.175	3/4	5/8	BUB-600-DB
TSHF-0231 x 2.5-DB	2 1/2	2 1/2	.024	5/16	3/16	BUB-187-DB	1-14 Threads						
1/2-13 Threads							TSH-1114 x 2-DB	2	2	.208	3/4	3/4	BUB-700-DB
TSH-0510 x 1.25-DB	1 1/4	1 1/4	.063	3/8	9/32	BUB-200-DB	TSH-1114 x 3-DB	3	3	.208	3/4	3/4	BUB-700-DB
TSH-0510 x 1.5-DB	1 1/2	1 1/2	.063	3/8	9/32	BUB-200-DB	TSH-1114 x 4-DB	4	2 1/2	.208	3/4	3/4	BUB-700-DB
TSH-0510 x 2-DB	2	2	.063	3/8	9/32	BUB-200-DB	TSHF-1114 x 4-DB	4	4	.208	3/4	3/4	BUB-700-DB
TSH-0510 x 2.5-DB	2 1/2	1 1/2	.063	3/8	9/32	BUB-200-DB							
TSHF-0510 x 2.5-DB	2 1/2	2 1/2	.063	3/8	9/32	BUB-200-DB							
TSH-0510 x 3-DB	3	1 1/2	.063	3/8	9/32	BUB-200-DB							
TSHF-0510 x 3-DB	3	3	.063	3/8	9/32	BUB-200-DB							
1/2-20 Threads													
TSH-0500 x 1.25-DB	1 1/4	1 1/4	.063	3/8	9/32	BUB-200-DB							
TSH-0500 x 1.5-DB	1 1/2	1 1/2	.063	3/8	9/32	BUB-200-DB							
TSH-0500 x 2-DB	2	2	.063	3/8	9/32	BUB-200-DB							
TSH-0500 x 2.5-DB	2 1/2	1 1/2	.063	3/8	9/32	BUB-200-DB							
TSHF-0500 x 2.5-DB	2 1/2	2 1/2	.063	3/8	9/32	BUB-200-DB							
TSH-0500 x 3-DB	3	1 1/2	.063	3/8	9/32	BUB-200-DB							
TSHF-0500 x 3-DB	3	3	.063	3/8	9/32	BUB-200-DB							